

Pressure Sensors for Semiconductor

DESCRIPTION

The Vacuum Sensor is a pressure sensor developed for semiconductor manufacturing, analytical instruments, and industrial vacuum systems. It provides stable and repeatable measurement performance across a wide vacuum range. The sensor supports an operating range from ultra-high vacuum levels below 1 Torr up to 1,000 Torr, making it broadly applicable to semiconductor processes and advanced industrial equipment.

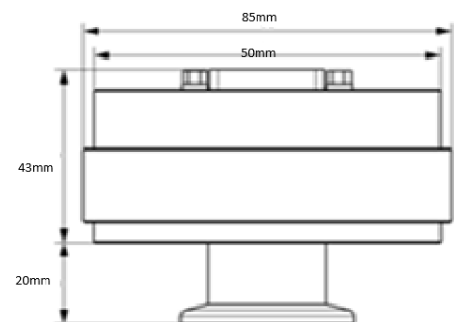
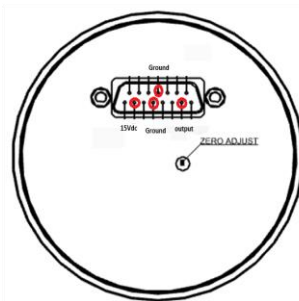

SPECIFICATIONS

Performance

Pressure range	0.1Torr	1Torr	10Torr	1,000 Torr
Proof Pressure	3,375 Torr			
Burst Pressure	6,750 Torr			
Accuracy	0.25% of Reading , 0.5% for < 1Torr			
Operating temperature	0°C ~ 100 °C			

Electrical

Supply voltage	15Vdc ± 5% VDC
Supply current	600 mA (max.)
Sensor output	Analog 0 ~ 10Vdc

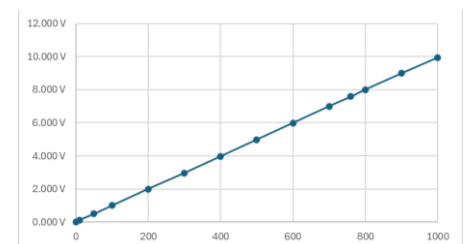

FEATURES

- Analog Output (Voltage)
- Measuring range 0.1, 1, 10, 1000 Torr
- ± 0.25% of Reading (0.5% for < 1Torr)

APPLICATION

- Semiconductor

THESEN

SENSOR SOLUTION DIVISION

16 Venture-ro 100beon-gil, Yeonsu-gu,
Incheon, 22013, Korea
Tel. 82-2-3458-7634
Fax. 82-2-3458-7629

SALES yj_lee@daeyang.co.kr



THESEN QR Code

You can see more detailed information about our products take a QR.

DEMENSIONS

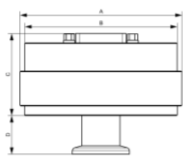
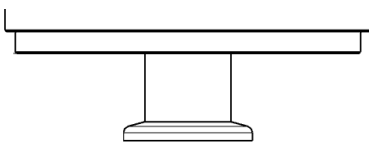
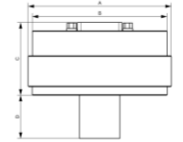
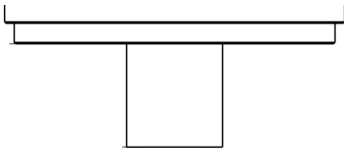
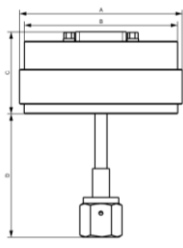
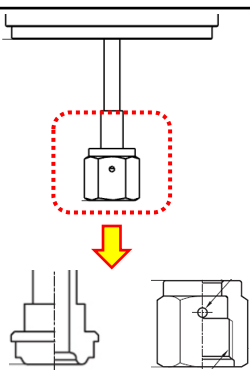
No	Fitting Type	Dimension											
1	 NW Type	 A	<table border="1"> <thead> <tr> <th>Flange Type</th> <th>A (mm)</th> </tr> </thead> <tbody> <tr> <td>NW16</td> <td>30</td> </tr> <tr> <td>NW25</td> <td>40</td> </tr> <tr> <td>NW40</td> <td>55</td> </tr> </tbody> </table>		Flange Type	A (mm)	NW16	30	NW25	40	NW40	55	
Flange Type	A (mm)												
NW16	30												
NW25	40												
NW40	55												
2	 Bare Tube	 A	<table border="1"> <thead> <tr> <th>Flange Type</th> <th>A (mm)</th> </tr> </thead> <tbody> <tr> <td>1/2" OD</td> <td>12.7mm</td> </tr> </tbody> </table>		Flange Type	A (mm)	1/2" OD	12.7mm					
Flange Type	A (mm)												
1/2" OD	12.7mm												
3	 VCR Type	 A	<table border="1"> <thead> <tr> <th>Flange Type</th> <th>A</th> <th>B</th> </tr> </thead> <tbody> <tr> <td>4VCR</td> <td>1/4"</td> <td>1/4"</td> </tr> <tr> <td>8VCR</td> <td>1/8"</td> <td>1/8"</td> </tr> </tbody> </table>		Flange Type	A	B	4VCR	1/4"	1/4"	8VCR	1/8"	1/8"
Flange Type	A	B											
4VCR	1/4"	1/4"											
8VCR	1/8"	1/8"											

THESEN

SENSOR SOLUTION DIVISION

16 Venture-ro 100beon-gil, Yeonsu-gu,

Incheon, 22013, Korea

Tel. 82-2-3458-7634

Fax. 82-2-3458-7629

SALES yj_lee@daeyang.co.kr



THESEN QR Code

You can see more detailed information about our products take a QR.